

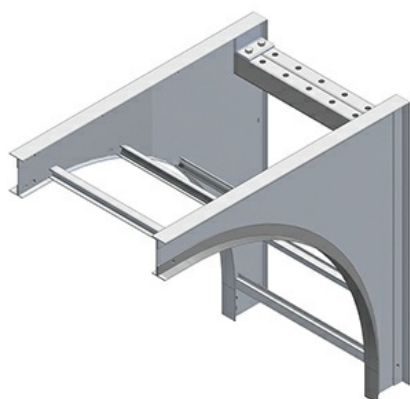

Cablofil
Vertical Cable Support Elbow
Part No. P303079



The aluminum I-beam design of ITray is perfect for industrial installations with large diameter cables in long span situations, minimizing total tray width and creating a smooth transition between straight sections and fittings. A structural offset in the sidewall creates strong, mid-span splices that need fewer supports. Each splice snaps in place and stays without holding. Additionally, only four bolts are needed for each splice reducing hardware needs by 50%. These features allow Itray to be installed up to 30% faster than standard tray.

Features & Benefits

Material: Aluminum Alloy 6063 and 5052

Finish: Plain

Bottom: LD: 1" wide rung SB: Flat sheet over rung SC: Solid Corrugated VC: Vented Corrugated

Construction: Welded

Tray Design: Tray construction and markings are per the latest edition of NEMA Standards Publication VE1, CSA C22.2 No. 126

Connectors: All fittings are supplied with necessary connectors and fasteners

Fitting heights (H): can be 4, 5, 6, and 7 inches tall

Specifications

General Info

Product Line	Cablofil	Finish	AL
UPC Number	800388089457	Country Of Origin	Mexico
Bottom Type	Ladder	Application Sector	Commercial, Industrial
Type	Supports, Vertical Elbows		

Dimensions

Product Width US	13.5 in	Product Weight US	16.22 lb
Product Volume US	7.508 cu ft	Product Depth US	31.0 in
Product Height US	31.0 in	Radius	24 in

Trade Programs

BAA	Yes
-----	-----
