

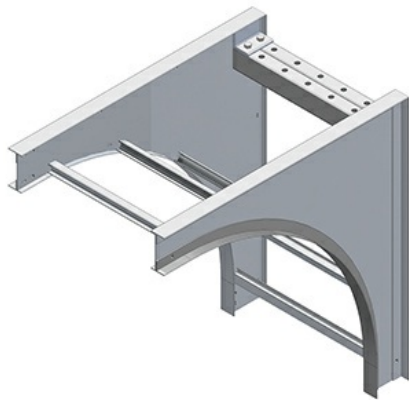

**Cablofil**  
**Vertical Cable Support Elbow**  
Part No. P303084



The aluminum I-beam design of ITray is perfect for industrial installations with large diameter cables in long span situations, minimizing total tray width and creating a smooth transition between straight sections and fittings. A structural offset in the sidewall creates strong, mid-span splices that need fewer supports. Each splice snaps in place and stays without holding. Additionally, only four bolts are needed for each splice reducing hardware needs by 50%. These features allow Itray to be installed up to 30% faster than standard tray.

## Features & Benefits

Material: Aluminum Alloy 6063 and 5052

Finish: Plain

Bottom: LD: 1" wide rung SB: Flat sheet over rung SC: Solid Corrugated VC: Vented Corrugated

Construction: Welded

Tray Design: Tray construction and markings are per the latest edition of NEMA Standards Publication VE1, CSA C22.2 No. 126

Connectors: All fittings are supplied with necessary connectors and fasteners

Fitting heights (H): can be 4, 5, 6, and 7 inches tall

## Specifications

### General Info

Product Line	Cablofil	Finish	Aluminum
UPC Number	800388089501	Country Of Origin	Mexico
Bottom Type	Ladder	Application Sector	Commercial, Industrial
Type	Supports, Vertical Elbows		

### Dimensions

Product Width US	43.5 in	Product Weight US	21.221 lb
Product Volume US	24.192 cu ft	Product Depth US	31.0 in
Product Height US	31.0 in	Radius	24 in

---

Trade Programs

---

BAA	Yes
-----	-----

---