

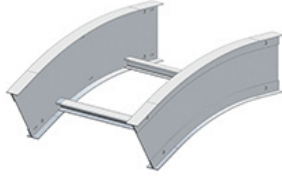

Cablofil  
6A-DIV-90VO24-S6 DIVIDER 6H 90° OVR 24R (TRA)  
Part No. P319073



The aluminum I-beam design of ITray is perfect for industrial installations with large diameter cables in long span situations, minimizing total tray width and creating a smooth transition between straight sections and fittings. A structural offset in the sidewall creates strong, mid-span splices that need fewer supports. Each splice snaps in place and stays without holding. Additionally, only four bolts are needed for each splice reducing hardware needs by 50%. These features allow Itray to be installed up to 30% faster than standard tray.

## Features & Benefits

Material: Aluminum

Each divider includes two self-drilling screws

## Specifications

### General Info

Product Line	Cablofil	Finish	Aluminum
UPC Number	800388468207	Country Of Origin	Mexico

### Dimensions

Product Width US	0.49 in	Product Weight US	2.292 lb
Product Volume US	0.306 cu ft	Product Depth US	32.842 in
Product Height US	32.842 in		

### Buy American Act Compliance

BAA Yes