

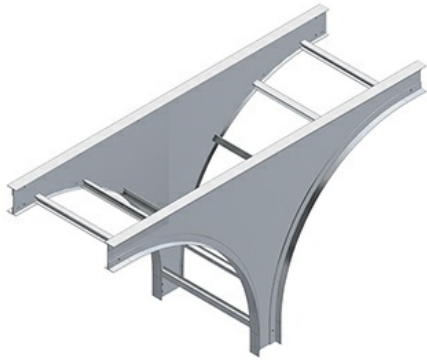

Cablofil
VC-6A-TD24-24 AL 6H VERT TEE DWN 24R 24W
Part No. P644197



Choose from an extensive selection of metallic ladder tray with a variety of rung and bottom styles to choose from. Finishes include steel, 304L and 316L stainless steel to meet the needs of any application. Rail heights range from 4" to 7" and width sizes are available up to 36".

Features & Benefits

Includes 2 pairs of splices and hardware

Specifications

General Info

Product Line	Cablofil	Finish	AL
UPC Number	800388159112	Country Of Origin	Mexico

Dimensions

Product Width US	25.5 in	Product Weight US	36.632 lb
Product Volume US	29.219 cu ft	Product Depth US	60.0 in
Product Height US	33.0 in		

Buy American Act Compliance

BAA	Yes
-----	-----