

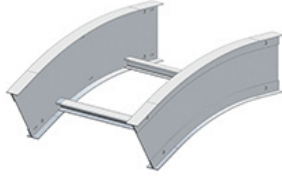

Cablofil
SB-6A-30VO24-12 AL 6H 30 OVR 24R 12W
Part No. P645437



The aluminum I-beam design of ITray is perfect for industrial installations with large diameter cables in long span situations, minimizing total tray width and creating a smooth transition between straight sections and fittings. A structural offset in the sidewall creates strong, mid-span splices that need fewer supports. Each splice snaps in place and stays without holding. Additionally, only four bolts are needed for each splice reducing hardware needs by 50%. These features allow Itray to be installed up to 30% faster than standard tray.

Features & Benefits

Includes splices and hardware

Specifications

General Info

Product Line	Cablofil	Finish	AL
UPC Number	800388170193	Country Of Origin	Mexico

Dimensions

Product Width US	13.5 in	Product Weight US	6.004 lb
Product Volume US	1.06 cu ft	Product Depth US	14.625 in
Product Height US	9.28 in		

Buy American Act Compliance

BAA	Yes
-----	-----