

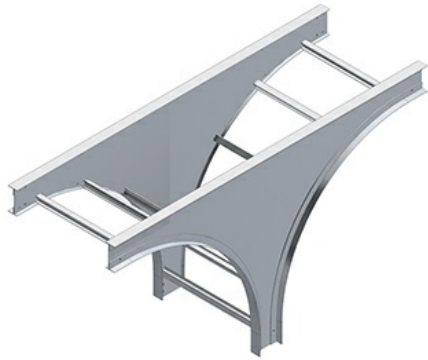

Cablofil
SB-4A-TD24-24 AL 4H VERT TEE DWN 24R 24W
Part No. P645522



The aluminum I-beam design of ITray is perfect for industrial installations with large diameter cables in long span situations, minimizing total tray width and creating a smooth transition between straight sections and fittings. A structural offset in the sidewall creates strong, mid-span splices that need fewer supports. Each splice snaps in place and stays without holding. Additionally, only four bolts are needed for each splice reducing hardware needs by 50%. These features allow Itray to be installed up to 30% faster than standard tray.

Features & Benefits

Includes 2 pairs of splices and hardware

Specifications

General Info

Product Line	Cablofil	Finish	AL
UPC Number	800388535084	Country Of Origin	Mexico

Dimensions

Product Weight US	10.802 lb
-------------------	-----------

Buy American Act Compliance

BAA	Yes
-----	-----