

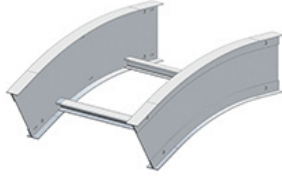

Cablofil  
SB-6A-30VO12-06 AL 6H 30 OVR 12R 06W  
Part No. P645552



The aluminum I-beam design of ITray is perfect for industrial installations with large diameter cables in long span situations, minimizing total tray width and creating a smooth transition between straight sections and fittings. A structural offset in the sidewall creates strong, mid-span splices that need fewer supports. Each splice snaps in place and stays without holding. Additionally, only four bolts are needed for each splice reducing hardware needs by 50%. These features allow Itray to be installed up to 30% faster than standard tray.

## Features & Benefits

Includes splice plates

## Specifications

### General Info

Product Line	Cablofil	Finish	AL
UPC Number	800388170087	Country Of Origin	Mexico

### Dimensions

Product Width US	13.5 in	Product Weight US	3.501 lb
Product Volume US	1.06 cu ft	Product Depth US	14.625 in
Product Height US	9.28 in		

### Buy American Act Compliance

BAA	Yes
-----	-----