

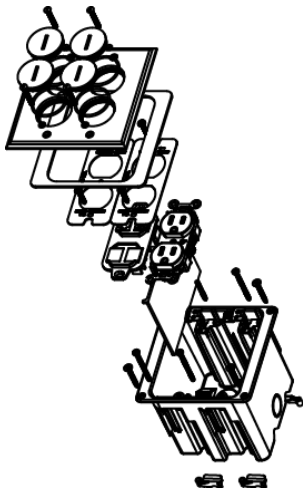

Wiremold
WMFB2DRKS4N Series Dual-Gang Floor Box Assembly
Part No. WMFB2DRKS4N



Includes dual-gang box, one 15A tamper-resistant duplex receptacle, 106 adapter with four openings for communication devices, and nickel cover with four screw plugs. For hole cut dimensions, see installation instructions sheet. Box Dimensions: 3 1/4" W x 3 3/4" L x 3 7/8" D (83mm W x 95mm L x 98mm D) Device Plate: 4 7/8" W x 5 1/16" L (124mm W x 129mm L).

Features & Benefits

Includes dual-gang box, one 15A tamper-resistant duplex receptacle, Box Dimensions: 3 1/4" W x 3 3/4" L x 3 7/8" D (83mm W x 95mm L x 98mm D) Device Plate: 4 7/8" W x 5 1/16" L (124mm W x 129mm L).
106 adapter with four openings for communication devices, and
nickel cover with four screw plugs.

For hole cut dimensions, see installation instructions sheet.

Specifications

General Info

Product Line	Wiremold	UPC Number	786564054030
Country Of Origin	China	Construction	Not Assembled
Cover Style	Surface	Cover Material	Nickel
Application Sector	Commercial, Residential	Standard	cULus Listed Nonmetallic Outlet Boxes: File E143222 Guide QCMZ. Meets Article 314.27(C) of NEC.
Warranty Type	1-Year from Installation or 2-Years from Day of Sale	Type	Floor Box

Dimensions

Product Width US	3.25 in	Product Weight US	1.76 lb
------------------	---------	-------------------	---------

Product Depth US	3.875 in	Knockout Size	1/2 in, 3/4 in
------------------	----------	---------------	----------------

Listing Agencies / 3rd Party Agencies

cULus Listed	Yes
--------------	-----

Additional Information

RoHS Compliant	Yes
----------------	-----

Technical Information

Floor Type	Wood	Service Capacity	Dual
Minimum Floor Depth	5 in	Box Capacity	2 Gangs
Cable Entry	Through Floor	Box Type	Recessed
Number of Outlets	2	Depth Behind Device Plates	3.87 in