

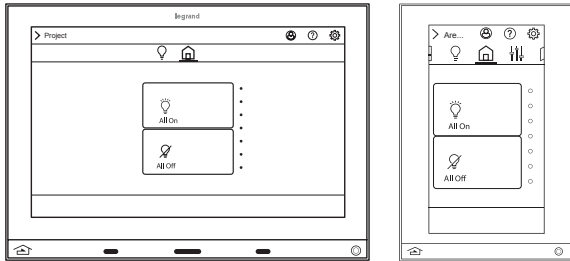



EQ73TB-TI-LITE / EQ41TB-TI-LITE • Les Numéros de Catalogue • Los Números de Catálogo:Country of Origin: Made in China • Pays d'origine: Fabriqué en Chine • País de origen: Hecho en China

OVERVIEW



Legrand's Equinox 73/41 LITE active matrix LCD touchscreen continues Legrand's commitment to LCD in-wall control centers. The Equinox 73/41 Lite interface is a dedicated system portal to whole system control. The 7" and 4" touchscreen displays media rich widgets in a dashboard layout. Each widget's content has been carefully designed to provide the ultimate user experience. Legrand's Equinox 73/41 LITE system uses self discovering technology, eliminating countless hours of tedious programming. Navigate and control, with real time feedback, lighting, shades, timers, scenes, and more through a single layer navigation experience.

FEATURES AND OPERATION OVERVIEW

- EQ73-LITE uses landscape orientation only; EQ41-LITE uses portrait orientation only
- Equinox platform provides built-in widgets using Legrand proprietary auto discovery methods for fast automatic screen design
- Equinox 73/41 LITE fully incorporates Legrand's consistent user experience interface, eliminating learning curves normally associated with switching between interface devices
- Powered over PoE*/PoE+ Ethernet
 - *Optional PoE Switch by others
- Communicates over Ethernet Bus (InFusion controller and Equinox should be connected to the same local network)
- Firmware upgradeable from Design Center over Ethernet
- Built-in ambient light sensor for "active," AUTO mode screen brightness and off when dark option when "inactive"
- Inactive mode dims or turns screen off in 1 minute if no activity
- Built-in proximity activation, 6" maximum, sets screen to active brightness when approached
- Dual operation mechanical buttons, bottom left and right;
 - Left  navigates to default widget
 - Right  may be programmed with a task from Design Center
- Equinox 73/41 LITE use the same widgets as Android tablets and phones, and iPads®, iPhones, and iPods
- Multiple user profiles are supported on the system. Using a variety of users you can limit what is available to specific individuals as well as limit permissions.
- Top of screen displays:
 -  - User details
 -  - Access help topics
 -  - Manage settings including appearance, access/permissions, areas and rooms, devices, events, groups, repair, schedules, scenes, and systems
- Main screen automatically displays widgets (order may be changed in user/settings directly from the app) including lighting, scenes, shades, and HVAC
- Raise/lower dimmable loads with graphical icons and text track color load status

FEATURES AND OPERATION OVERVIEW *(continued)*

- Manual reboot of Equinox 73/41 LITE – press and hold **both** mechanical buttons until screen goes dark (about 3 seconds), then release



NOTE: If buttons are held in too long, the screen will boot to *service mode*, and will not load the application code. Repeat manual reboot – without holding buttons to long – to clear this mode.

- Station reset into *Service Mode* – simultaneously press and hold both mechanical buttons for ten seconds
 - Service mode is automatically used when updating firmware from Design Center
 - If the application code is corrupt it may cause the screen to lock, preventing Design Center from updating or reloading the firmware. Use this option to reboot the screen to service mode allowing Design Center to update the corrupted firmware.
 - To manually exit *Service Mode* use the *Station Reset* option

SPECIFICATIONS

Description	Specification - EQ73-LITE	Specification - EQ41-LITE
Dimensions, HWD (at wall surface)	4.9" x 6.9" x 0.37" (124mm x 175mm x 9mm)	4.9" x 3.44" x 0.44" (124mm x 87mm x 11mm)
Dimensions, HWD (overall)	4.9" x 6.9" x 2.1" (124mm x 175mm x 53mm)	4.9" x 3.44" x 1.1" (124mm x 87mm x 28mm)
Weight	1.6 lb or 725.75g	8.8 oz. or 249.5g
Display	Active Matrix Color LCD	Active Matrix Color LCD
Display Size	7" diagonal	
Display Resolution	800 x 480 pixels	
Finish	Trim: Titanium (TI), Nickel (NI) Touchscreen: Black Glass	Trim: Titanium (TI), Nickel (NI) Touchscreen: Black Glass
Power	Ethernet with PoE, PoE+	Ethernet with PoE, PoE+, 5W
Surge Suppression	Yes	Yes
Mounting	See <i>Installation</i> section below	US/European style, single gang, wall boxes or low-voltage brackets
LCD Button Status		Automatic (white = off, orange = on)
Maximum Gangs		Single gang only
Wiring Connections	Communication: Ethernet RJ45 Power: PoE/PoE+	Communication and power: PoE/PoE+ via Ethernet RJ45
Addressing	Self addressing through software	Self-addressing through software
Glass Surface	Chemically strengthened	Chemically strengthened
Ambient Operating Temperature	32-95°F (0-35°C)	32-95°F (0-35°C)
Ambient Operating Humidity	5-95% non-condensing	5-95% non-condensing
CE and FCC Compliant	Yes	Yes

SYSTEM REQUIREMENTS

Equinox 41/73-LITE is compatible with InFusion Design Center version 4.3.X software or higher. For new projects it is recommended that firmware and software be kept to the most current release. It is advised to update Equinox station firmware to match that of Design Center to ensure updates and features are consistent for operation.

EULA

"In order to enhance the security of our products, Legrand ships its products with all insecure ports closed and insecure protocols disabled. You are free to configure your device as needed, but in doing so note that you may be decreasing the security of your device and any information contained in the device. As you modify the device's default settings, keep in mind how this may impact the security of the device and your network. In addition, you should use caution in connecting your device to the Internet, especially if you have altered the default security settings. If you have any questions or concerns about how your modifications of the device may affect its security, please contact the Legrand customer service team at 1-800-879-8585 / <https://www.legrand.us/contact-and-support>

EQUINOX73-LITE STANDARD INSTALLATION (USING EQ73ST-INSTALL)

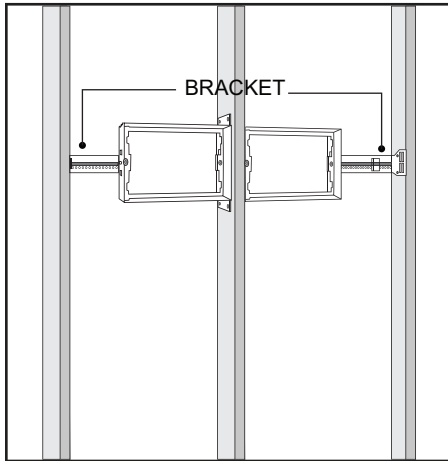

STEP 1. Mount left or right side of framing studs. The recommended mounting wall height is six inches above that of a typical keypad station or approximately 50" to 58" from the floor to the bottom of the wall box. However, it may be installed at any height fitting your installation requirements. It is recommended to use the 16" adjustable bracket, VHA-112, which adds considerable stability to any installation method.

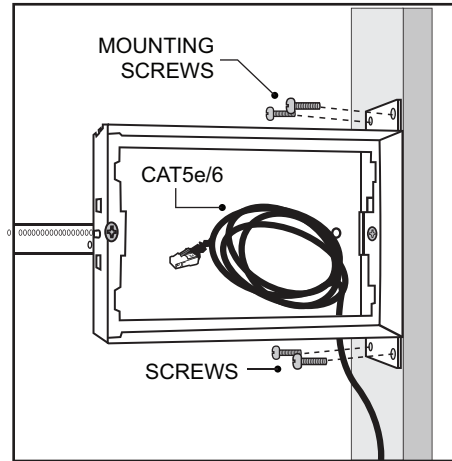

STEP 2. Secure to framing with screws and install CAT5e/6 PoE network cable. Mount the wall box to wall studs as illustrated. Mount the box so the mounting brackets are flush with the edge of the framing stud allowing sheetrock to wrap around the box when wall is finished. Insert the cardboard paint protector.

NOTE: Install Ethernet cable, CAT5e or better with PoE or PoE+ support before wallboard. Use one of the top or bottom 3/4" knock-outs. Secure CAT5e/6 cable using a 2-screw connector or equivalent. Terminate cable with an RJ45 connector.

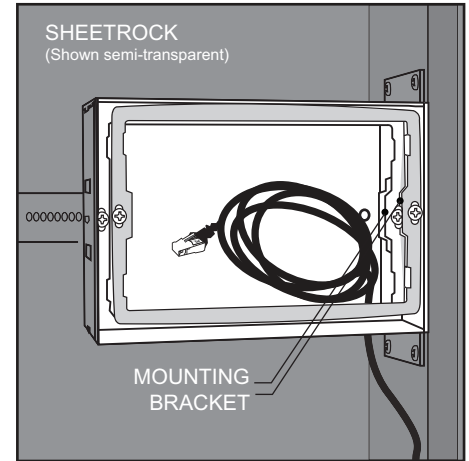

STEP 3. Adjust the mounting bracket for proper depth: set 1" (25mm) from the wall face (See Step 4). The sheetrock hole is cut to 4.38" high by 6.38" wide allowing the box to protrude part way into the sheetrock hole. The mounting bracket's depth must be set so when inserting the Equinox 73-LITE screen it will snap securely into the box – set at 1" from bracket to front of finished wall.

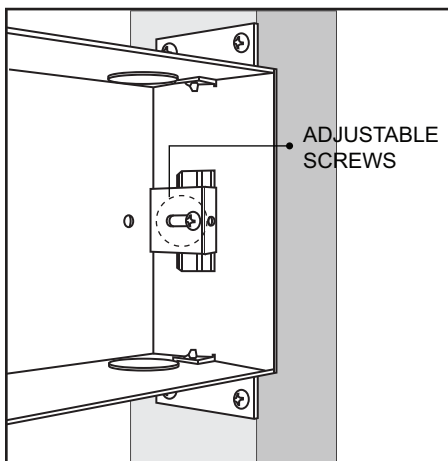

STEP 4. Loosen screws and slide in or out for proper depth. Slide the mounting bracket in or out until it fits the supplied depth guide shipped with the Equinox 73-LITE screen – 1" (25mm) from bracket to front of finished wall. Secure screws again when the depth has been set. See Mounting Ring Adjustment Tool card on pg 5. It is not necessary to remove the mounting bracket as illustrated - this has been done to simplify the illustration.

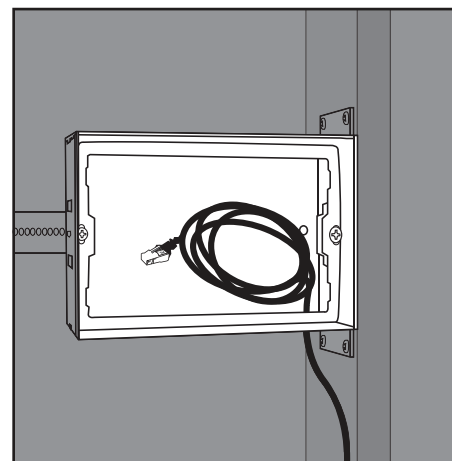

STEP 5. Finish by pulling wire. Pull the CAT5e/6 Ethernet wire connection through the bezel – if using the optional bezel – and connect to the Equinox 73-LITE touchscreen. It is now ready for the Equinox 73-LITE touchscreen installation.

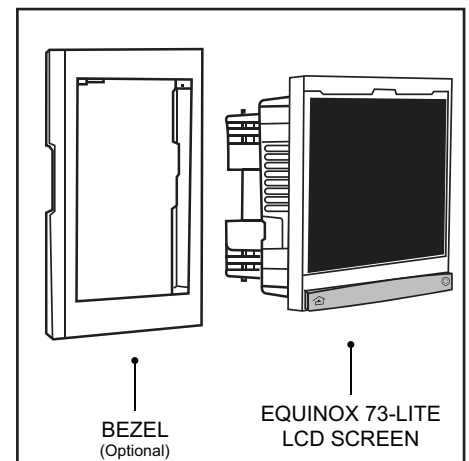

STEP 6. Insert and connect the Equinox 73-LITE or add optional bezel before insertion. At this point, attach the optional bezel then insert the Equinox 73-LITE touchscreen, carefully working straight back into the mounting bracket until secure.

SPRING CLIP INSTALLATION

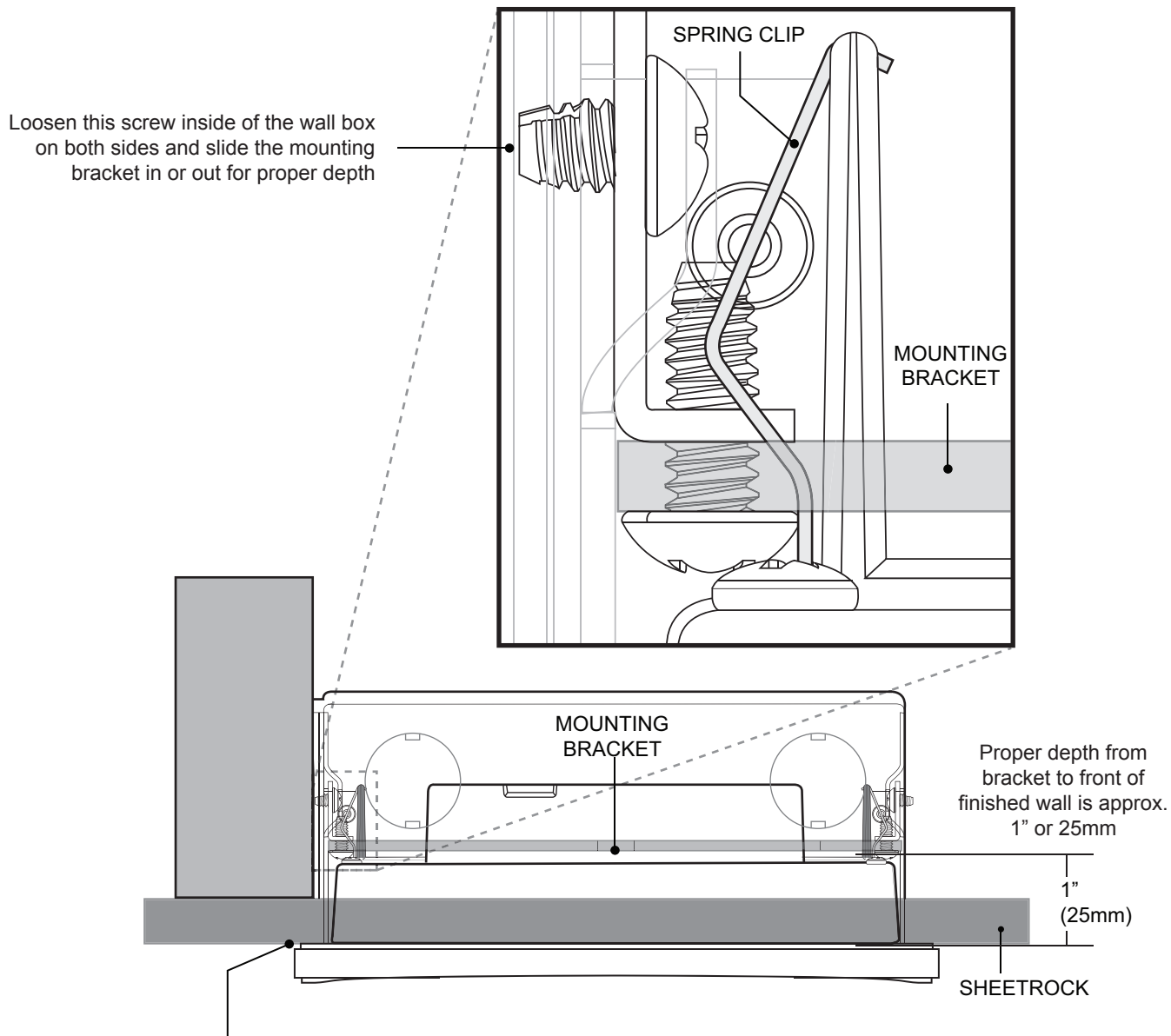

When the Equinox 73-LITE touchscreen is inserted, the back of the touchscreen's face is flush with the sheetrock and the spring clip is securely behind the mounting bracket. If the screen clip is not far enough behind the mounting bracket, then the mounting bracket's depth must be moved out, toward the front of the wall box, until the spring clip has a secure grip when the Equinox 73-LITE touchscreen is fully inserted into the wall box.

EQUINOX 73-LITE BACK BOX MULTI-VIEW

CAUTION: Left and right speakers of Equinox 73-LITE are exposed. Use extreme caution handling, installing and removing the Equinox 73-LITE. To avoid damage to either speaker, do not accidentally touch or push in on the speaker cones.

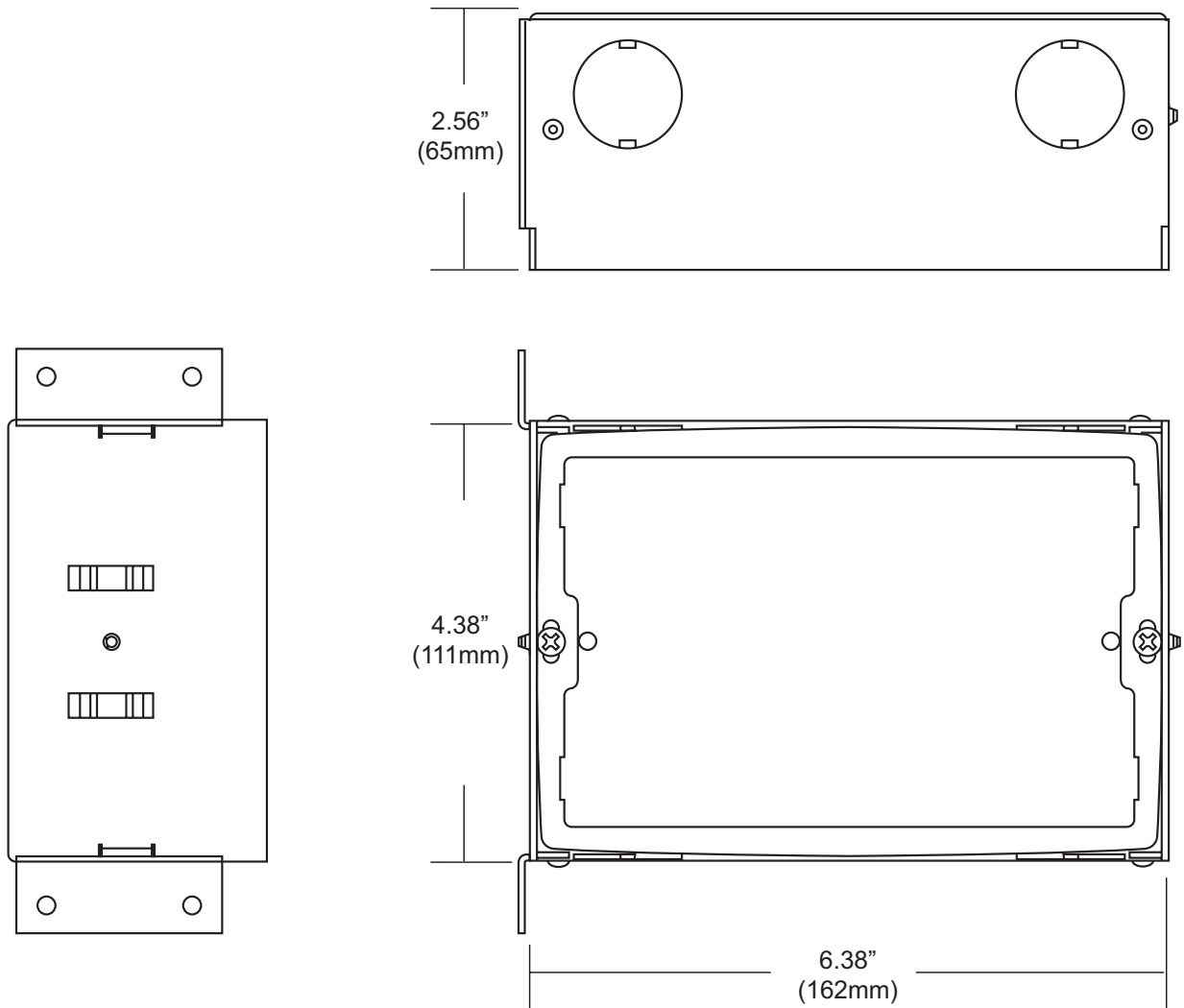

EQUINOX 73-LITE MOUNTING RING ADJUSTMENT TOOL

Locate this tool card which ships with the Equinox 73-LITE touchscreen. Inside the wall box is a rectangular ring that must be parallel with the wall surface and 1" behind the wall surface on the left and right sides. Loosen the two inside screws and use this tool to set the mounting ring depth at 1".

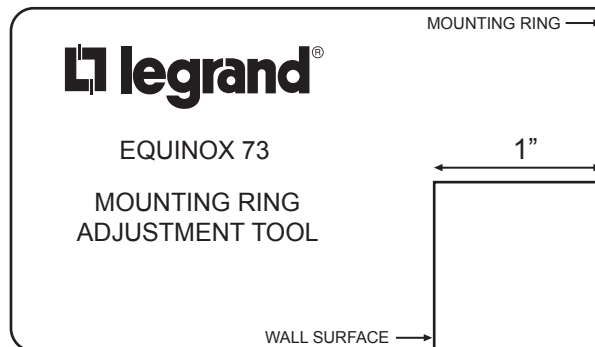

EQUINOX 73-LITE RETROFIT STATION INSTALLATION STEPS

Legrand's Equinox 73-LITE retrofit install kit (EQ73RE-INSTALL) is designed to mount the Equinox 73-LITE touchscreen directly to sheetrock without the added cost of the bezel, saving time and money. Installation of the Equinox 73-LITE should be performed or supervised by a certified installer. Begin by preparing the wall opening. The recommended mounting height is six inches above that of a typical keypad station or approximately 50" to 58" from the floor to the bottom of the Equinox 73-LITE touchscreen. However, it may be installed at any height fitting specific custom installation requirements.

NOTE: The installer must provide an Ethernet RJ-45 connection wire. Ethernet cable should be CAT5e or better with PoE or PoE+ support.

STEP 1. Cut the sheetrock. Cut a precise rectangular hole in the sheetrock – 6-3/8" wide x 4-3/8" high (162mm x 111mm). The hole should be **very clean-cut, exact and must be level**. Adjustable tolerances are extremely small and extra care should be taken in cutting the hole out. Adjustment to the inside ring (see figure 1A,) is limited or the edge of the install bracket will show.

a. Fine tune a small amount by tilting the ring slightly to level screen – see figure 1A below; illustration is exaggerated.

STEP 2. Insert bracket/bend wings. Place bracket into the hole and carefully bend the two sides back around to meet the back of the sheetrock as illustrated. Avoid over bending the wings. Do not screw sides in until step four.

STEP 3. Secure inside ring. Secure inside ring with the two screws provided.

STEP 4. Final screws. Secure completed assembly using the four self tapping screws angled as illustrated – two screws on each side. **DO NOT OVER TIGHTEN!**

STEP 5. Install the Equinox 73-LITE touchscreen. The retrofit bracket is now ready to receive an Equinox 73-LITE touchscreen by pressing straight back on both sides at the same time until locked and secure.

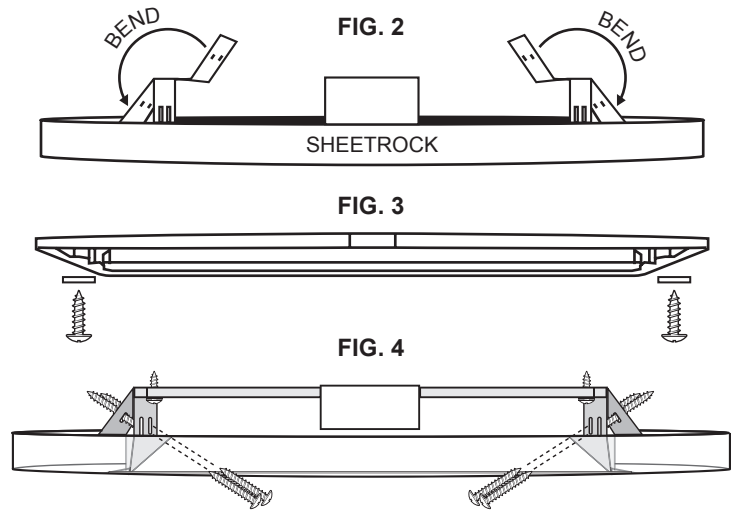
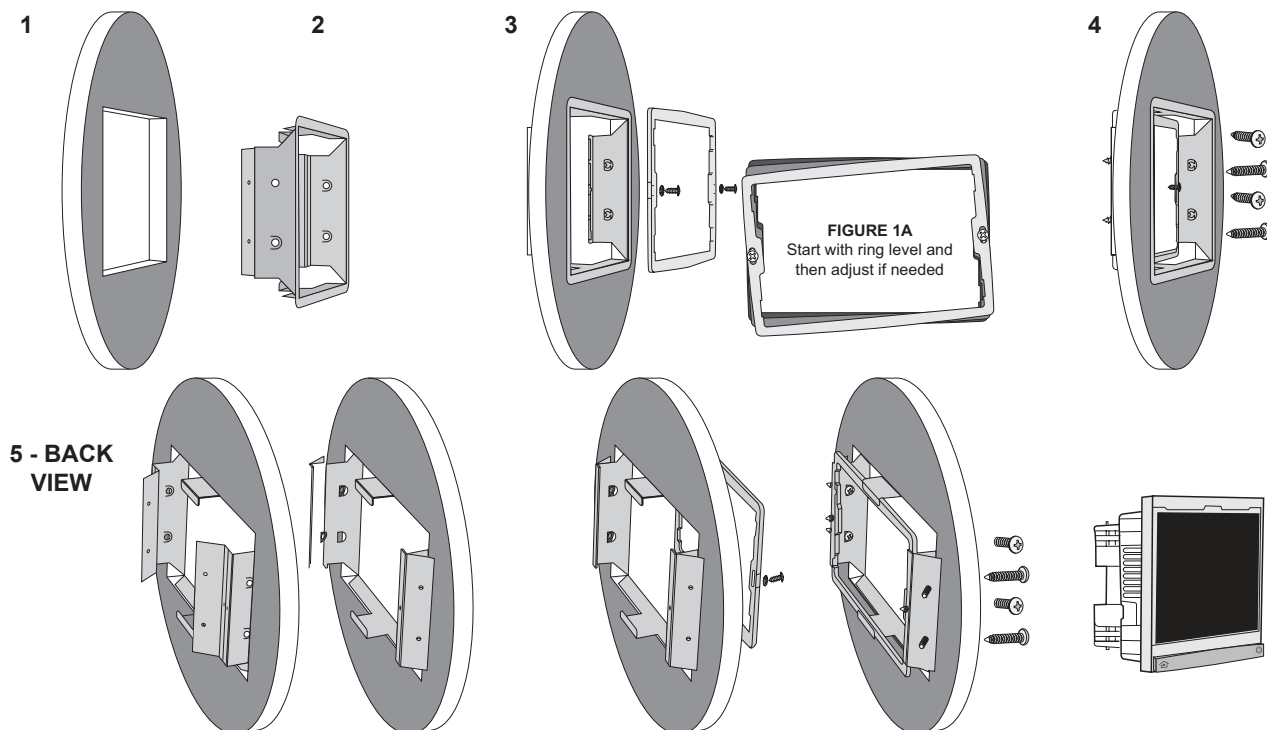
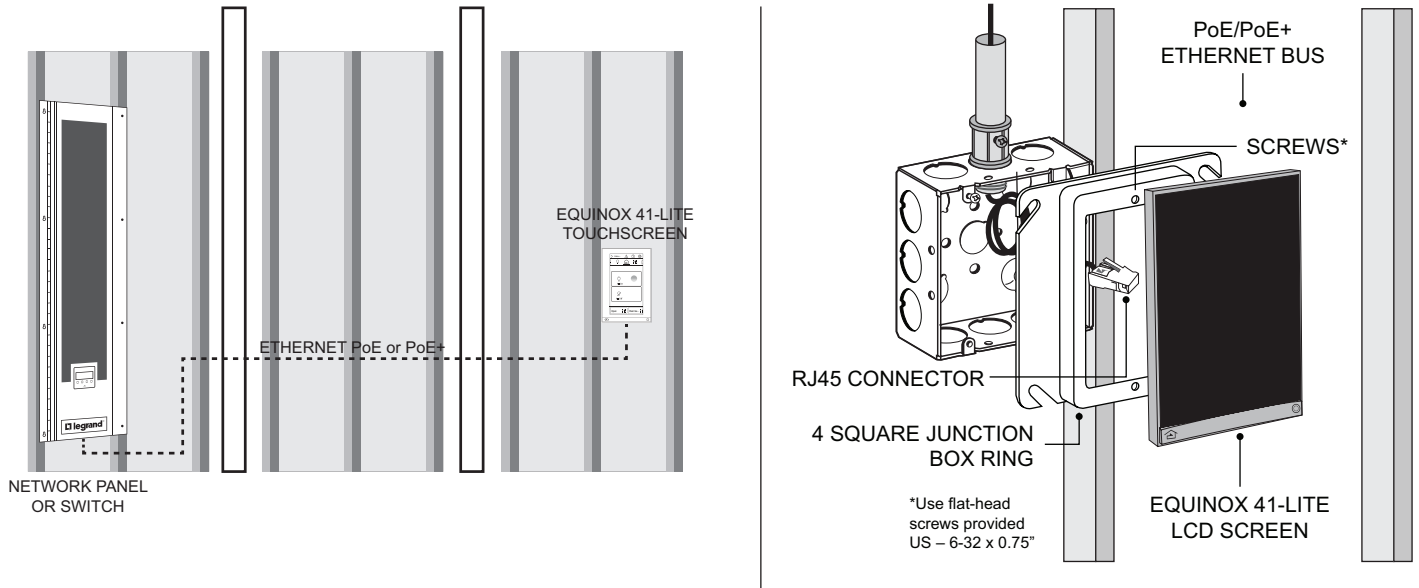

FIG. 5



EQUINOX 41-LITE STANDARD INSTALLATION



*Ethernet Bus: Power and communication; Ethernet, PoE or PoE+

EQUINOX 41-LITE STATION INSTALLATION STEPS

1. Run PoE Ethernet bus to four square junction box
2. Install ring with screws provided (figure A)
3. Connect RJ45 to station
4. Install station by rotating (figure B) and connecting the top first. Press station in and hold on bottom center while securing the hex screw with provided allen wrench (figure C)

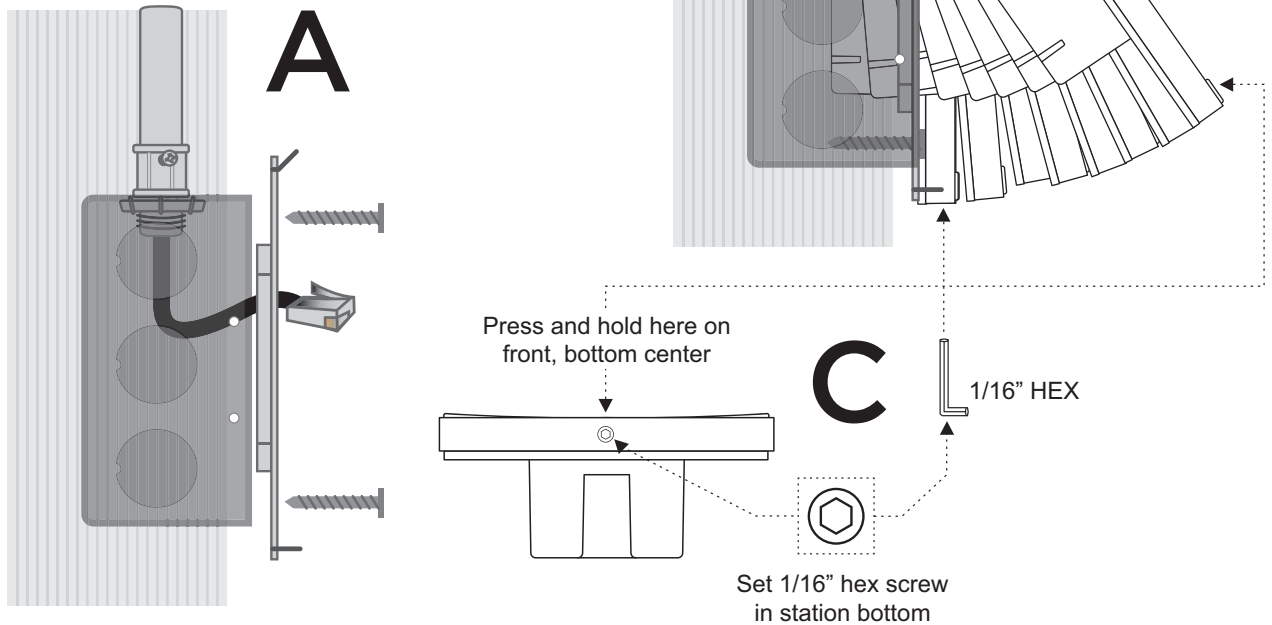

PREPARING THE TOUCHSCREEN FOR CONFIGURATION WITH DESIGN CENTER

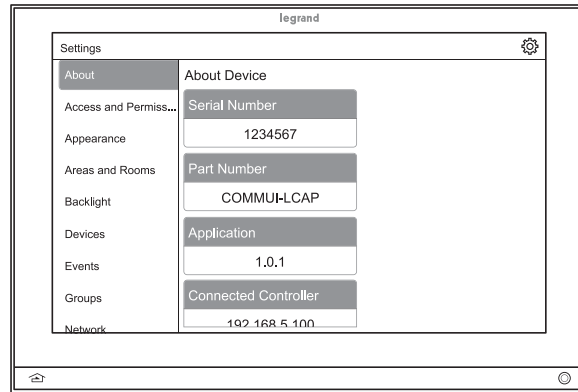

1. With the EQ73-LITE / EQ41-LITE powered, press the Menu icon in the upper right to access the setup menu. Select “About” and note the product serial number (this will be used to configure the matching station object in Design Center).

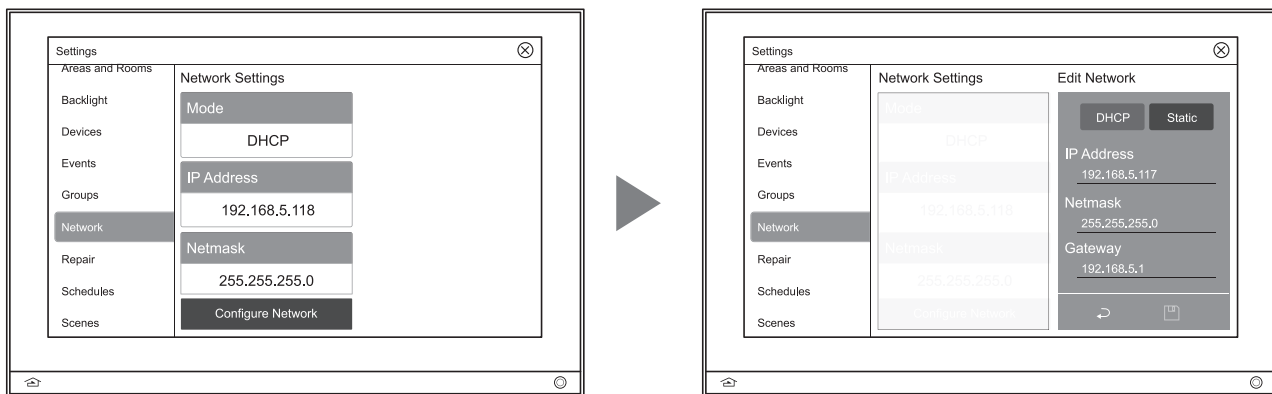

2. **Network** - Configure the network settings of Mode, IP Address, Netmask, Gateway, and DNS Server. Configure the network through DHCP or select Static settings to manually enter the IP Address, Netmask, Gateway, or DNS Server addresses.

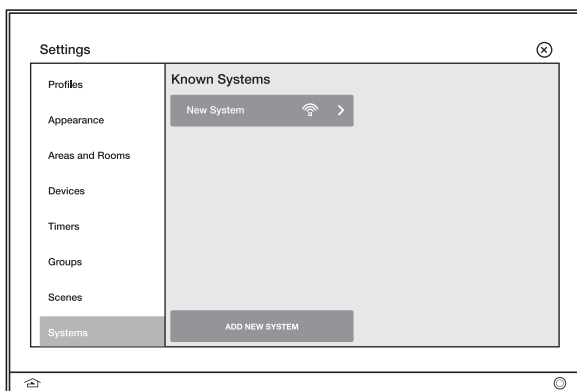

3. **Systems** - Scroll to the bottom of the Equinox menu and select **Systems**. Select the **New System** to enter the Project Name, Local IP Address of the main InFusion controller, Remote IP Address (optional), Passcode (as entered in the Project Information / Owner field of the Design Center project file), and select **Use As Default System**, then click the **Save** icon.

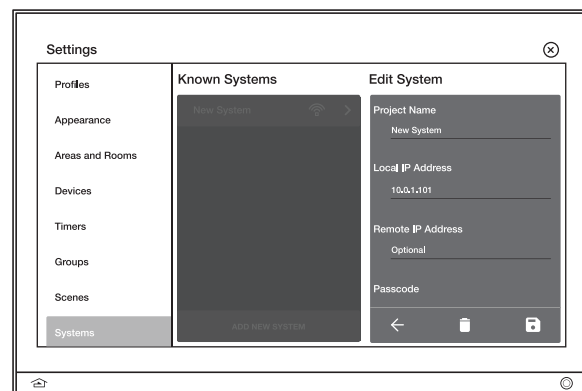

4. **Design Center** - See the Equinox Lite Users Guide for instructions about adding the Equinox Lite touchscreen to Design Center, and for additional instructions related to using the Equinox LITE features.

MULTI-VIEW LINE DRAWING - EQUINOX 73-LITE

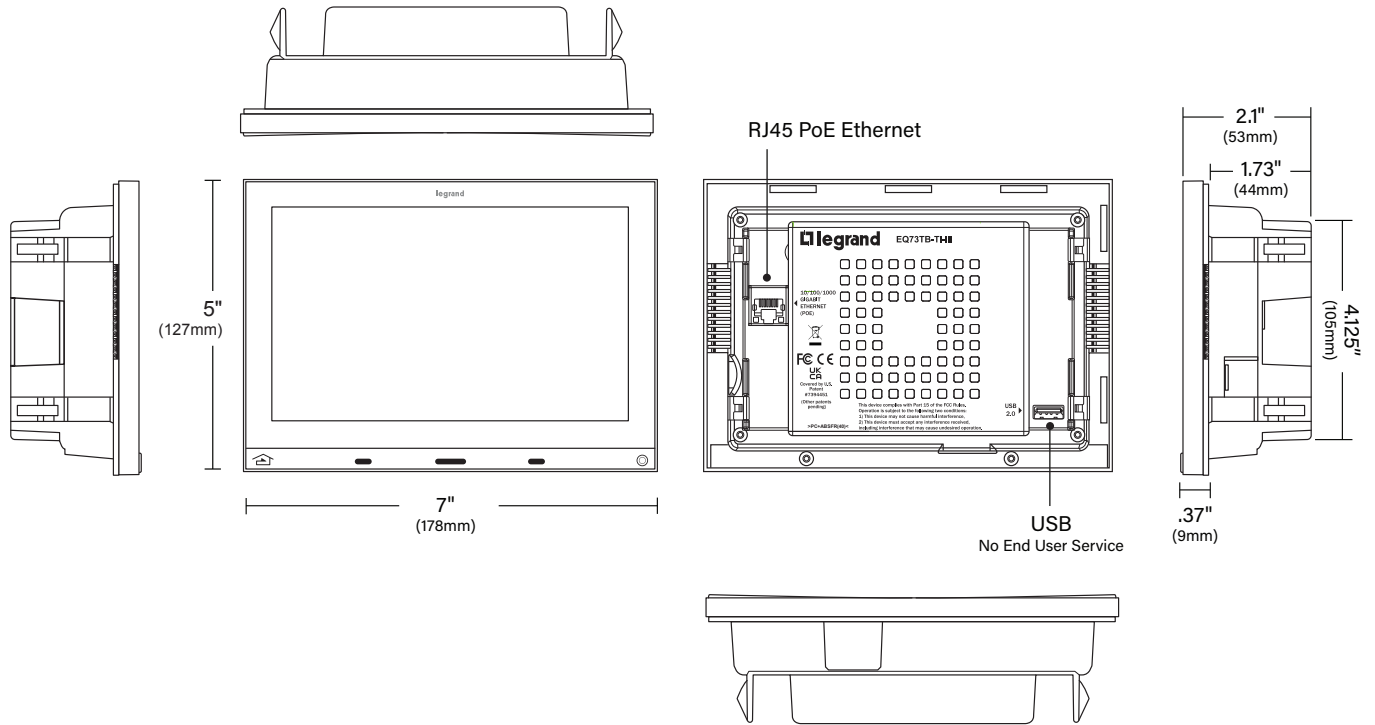

MULTI-VIEW LINE DRAWING - EQUINOX 41-LITE

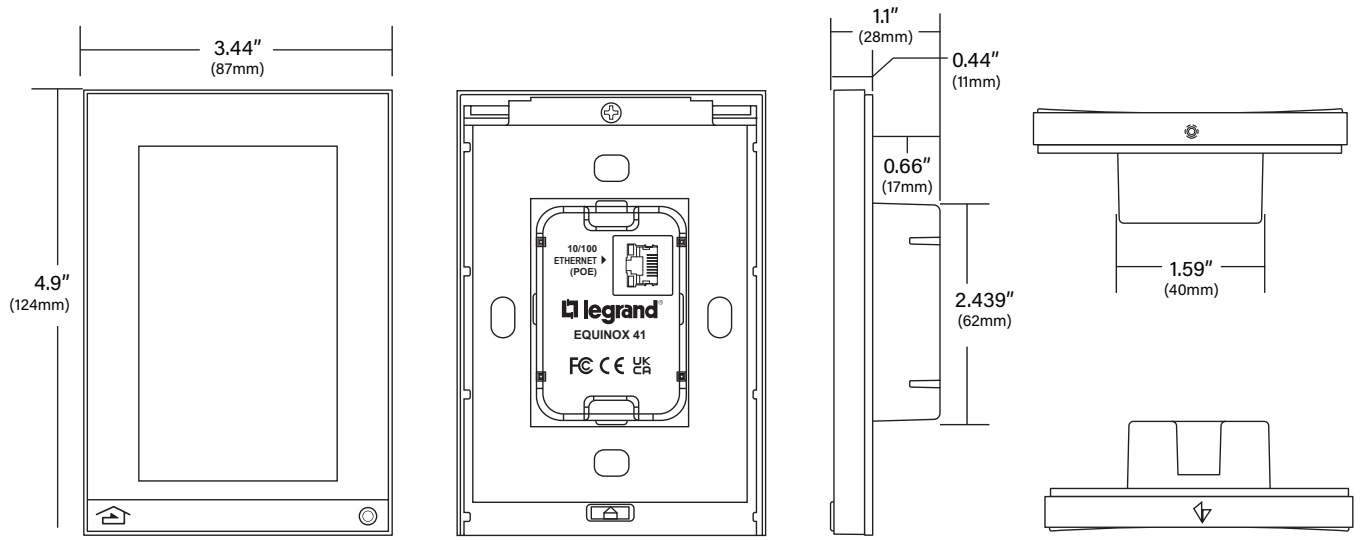

STATION CLEANING

CLEANING

- Dampen a soft cloth in water and wring-out to barely damp
- Use a light buffing motion to wipe clean
- Do not take the station apart
- **Never** spray station with any cleaners

NOTE:

Please reference local and NEC codes for appropriate electrical and communication install methodology

WARRANTY INFORMATION

Wattstopper warrants its products to be free of defects in materials and workmanship for a period of three (3) years. Touchscreens are warranted for 90 days. There are no obligations or liabilities on the part of Wattstopper for consequential damages arising out of, or in connection with, the use or performance of this product or other indirect damages with respect to loss of property, revenue or profit, or cost of removal, installation or reinstallation.

INFORMATIONS RELATIVES À LA GARANTIE

Wattstopper garantit que ses produits sont exempts de défauts de matériaux et de fabrication pour une période de trois (3) ans. Les écrans tactiles sont garantis pendant 90 jours. Wattstopper ne peut être tenu responsable de tout dommage consécutif causé par ou lié à l'utilisation ou à la performance de ce produit ou tout autre dommage indirect lié à la perte de propriété, de revenus, ou de profits, ou aux coûts d'enlèvement, d'installation ou de réinstallation.

INFORMACIÓN DE LA GARANTÍA

Wattstopper garantiza que sus productos están libres de defectos en materiales y mano de obra por un período de tres (3) años. Las pantallas táctiles están garantizadas por 90 días. No existen obligaciones ni responsabilidades por parte de Wattstopper por daños consecuentes que se deriven o estén relacionados con el uso o el rendimiento de este producto u otros daños indirectos con respecto a la pérdida de propiedad, renta o ganancias, o al costo de extracción, instalación o reinstalación.